

Judith and Marvin Herb Family Simulation Center at NCH

Where learning leads to lifesaving





Simulation Training

Simulation Training is experiential learning through active participation and subsequent reflection. Bridging the gap between knowledge and higher-level functioning.

What Can Simulation Accomplish

- Task training/procedural skills
- Scenario training
- Communication skills
- Quality improvement
- Handoffs
- Healthcare development
- Competency assessment
- Situational awareness
- Patient safety
- Teamwork/dynamics
- Skill refinement
- Improved patient satisfaction
- Process improvement
- Research and development

Who We Partner With

- Nurses
- Emergency physicians and practitioners
- Collier County school nurses and staff
- GME Medicine Residents
- OB Hospitalists
- Executive Leadership Teams
- Critical care physicians and practitioners
- Universities and Schools: Naples and Immokalee
- EMS, fire, paramedics, flight crew, police
- NP/PA training
- Robotic surgery training
- Film Productions
- Local Businesses





2023 Annual Learners' Hours

Simulations, and training classes during this time period.

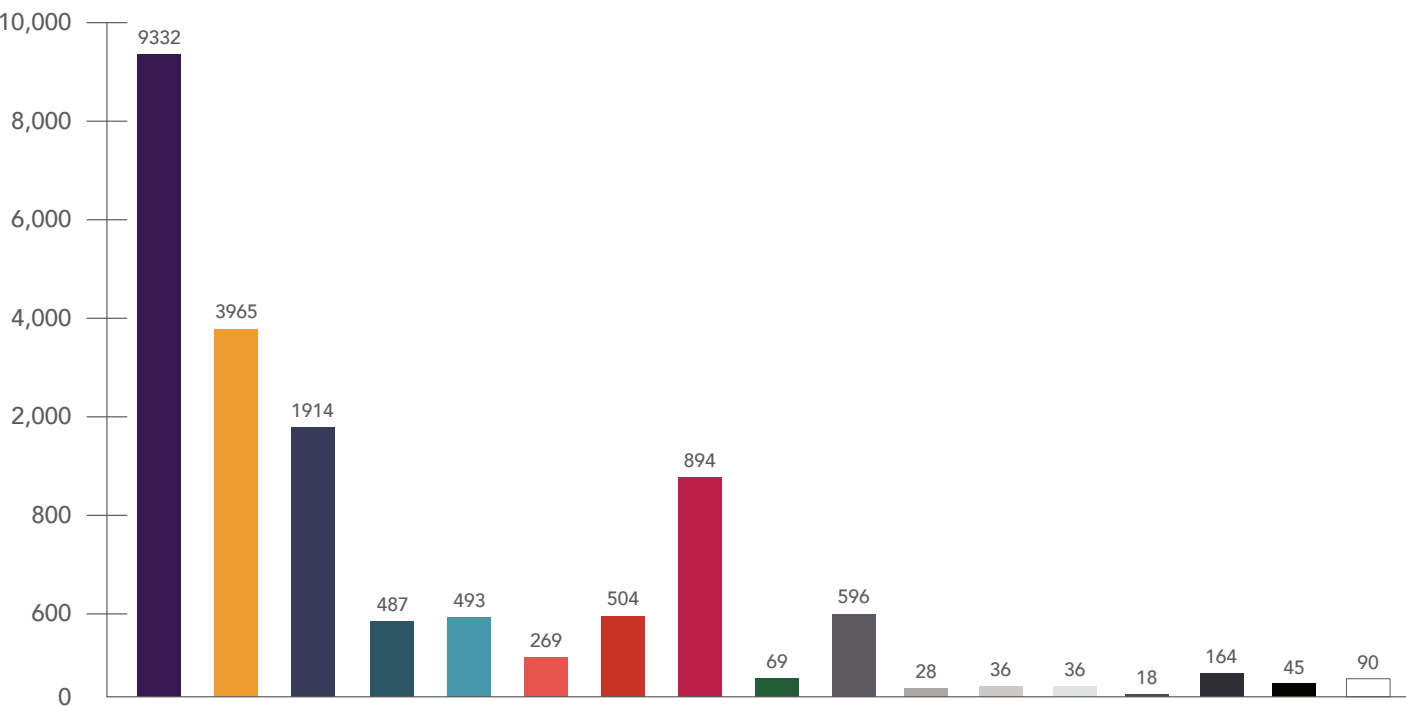

TOTAL LEARNERS' HOURS: 18,940

- | | |
|----------------------------|------------------------|
| Registered Nurses | First Responders |
| Physicians | Clinical Techs |
| Medical Assistants | Chaplan |
| Medical Students | Registrars |
| Nursing Students (College) | Environmental Services |
| Respiratory Therapists | High School Students |
| Operating Room Staff | Project Search |
| Leaders Administration | Volunteer Department |
| Public Safety | |



2023 Accomplishments

TOP 35

Simulation Centers
in the United States

BECKER'S
HOSPITAL REVIEW



18,940

Learner hours



4,320

Learners



192

Collier County First
Responders Trained



658

Classes

Facility

- 12,000 sq feet
- Multidisciplinary
- 5 simulation rooms
- 1 immersive room
- 1 operating room
- 1 procedural lab
- 1 moulage room
- 1 green room
- 3 classrooms
- 2 debrief rooms
- 1 conference room
- 1 learner lounge

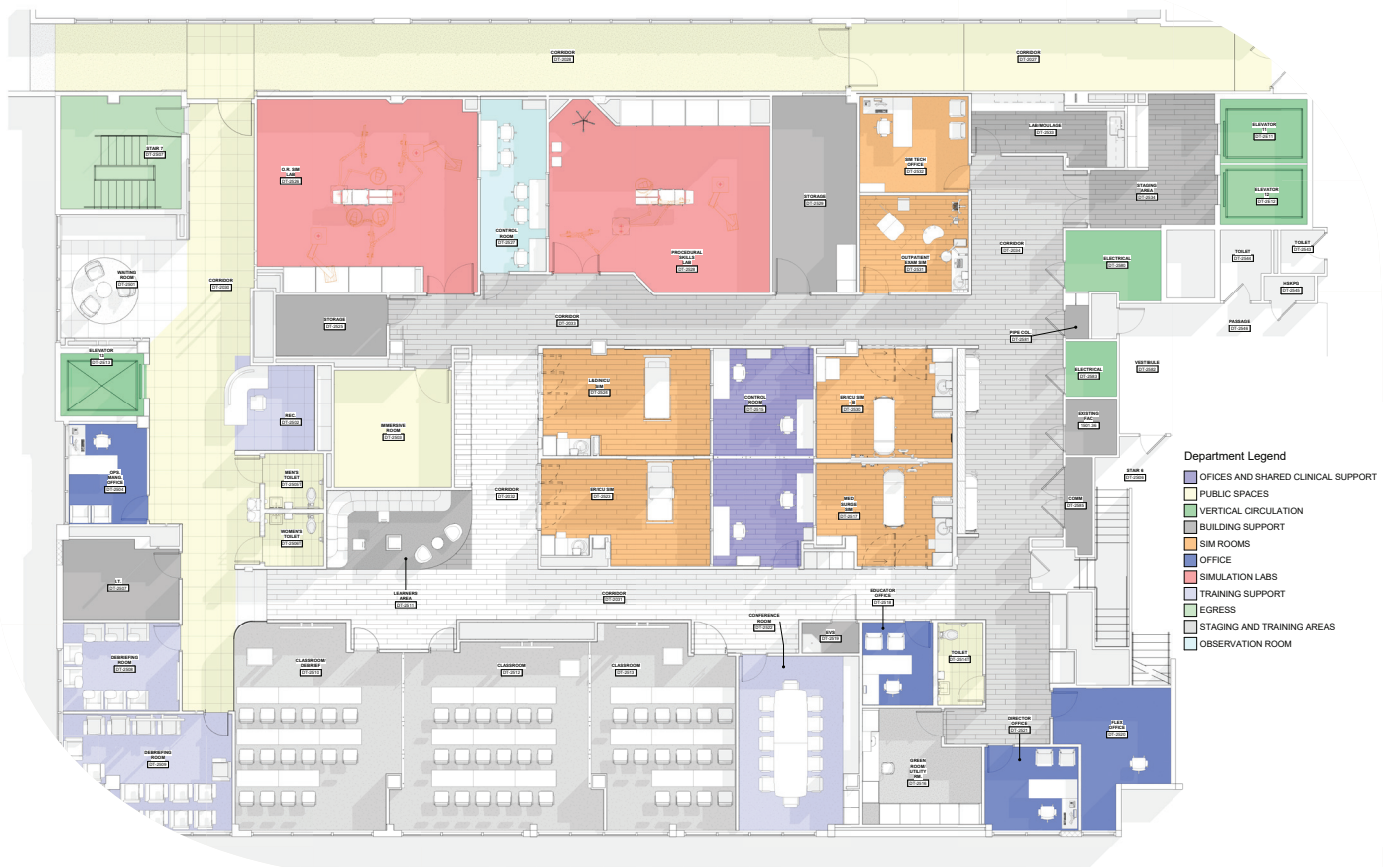



The NCH Judith and Marvin Herb Family Simulation Center at NCH runs on philanthropic support. These efforts allow our team to thrive in clinical excellence, patient safety, quality, and innovation. Fueled by donor support, we look forward to enhancing the quality of care at NCH by working with multiple service lines and helping people in our community in the upcoming years ahead.

Thank you to the many donors who support the Judith and Marvin Herb Family Simulation Center.

Our Future

We are working closely with the hospital and community to enhance the quality of care we give by performing high risk, low frequency simulation scenarios. We are broadening our users by extending the benefit of simulation to community partners.

To learn more scan the QR code or reach out to us at simulation@nchmd.org or 239-624-1250.

 facebook.com/NCHSimulationCenter

